

INSTALLATION INSTRUCTIONS

Soft Closer 60kg

Triline's soft close accessory is available for our standard Phoenix and Pro-Line60 cavity slider with doors weighing up to 60kg.

They can be installed at time of cavity door installation or at a later date.

REQUIREMENTS

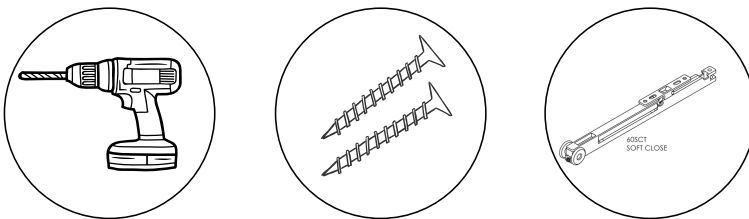

COMPONENTS

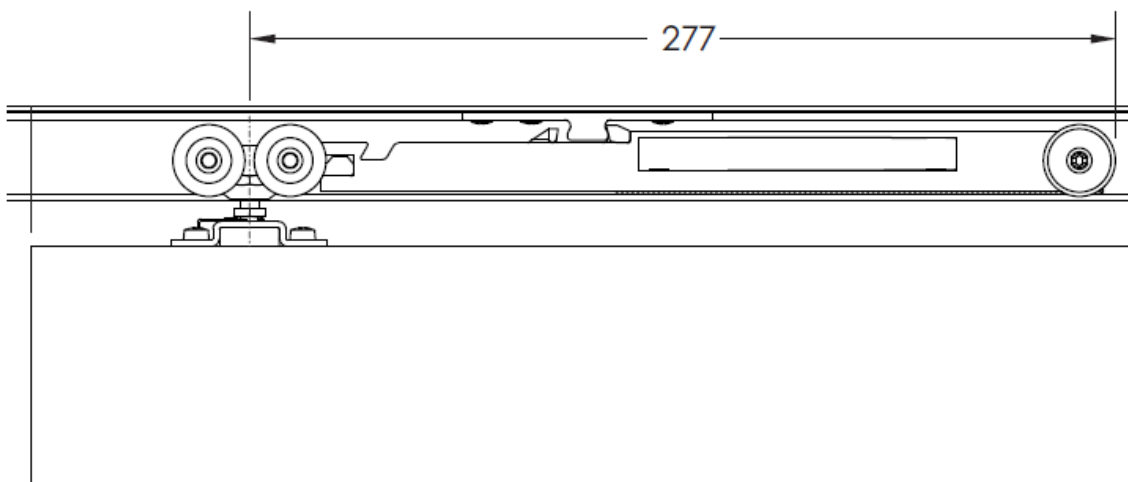
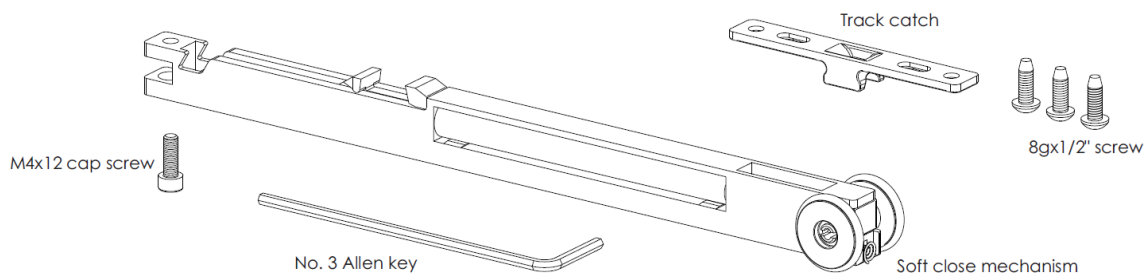

INSTRUCTIONS

- 1 Insert 1st hanger into track, then the soft closer. The soft close must be in primed position, as shown:

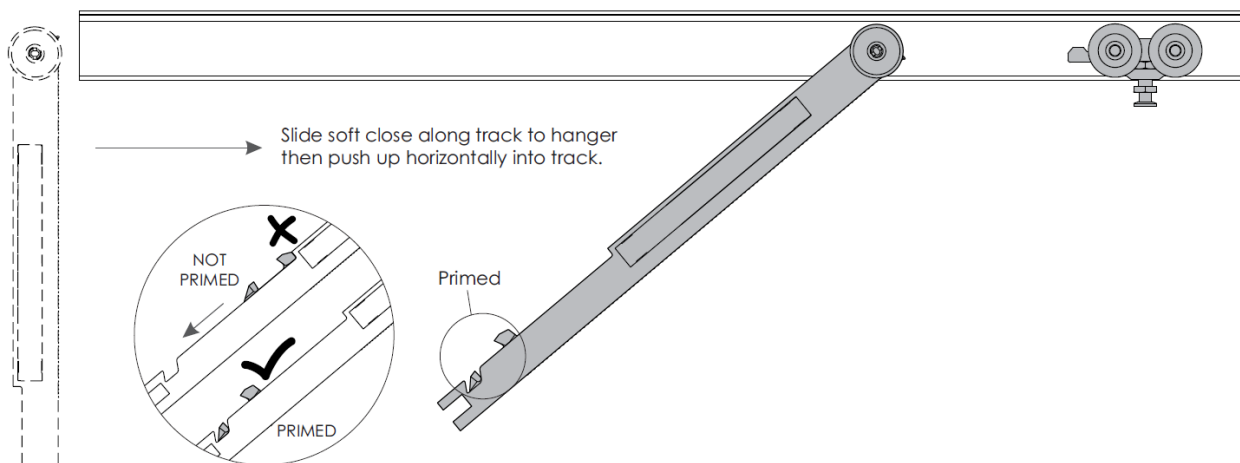

- 2 Insert 2nd hanger & attached hanger to soft close with cap screw. Install panel as per sliding door system instructions.

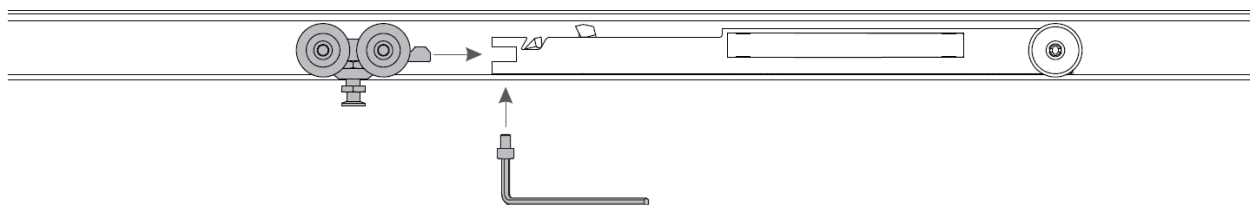

- 3 Fix catch plate into track through slotted holes with 2 screws only

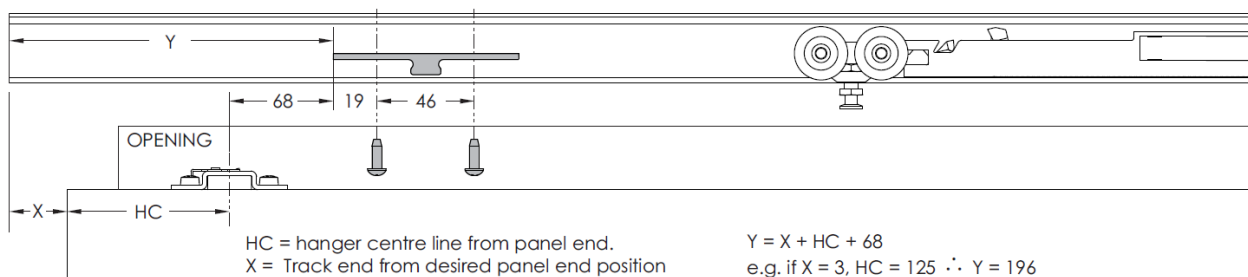

-
- 4** Close the panel to check if it closes to the desired position:
- If the panel stops too far away from the the jamb, move the catch plate closer to the jamb.
 - If the panel hits the jamb too soon, move the catch plate away from the jamb

Fine adjustment

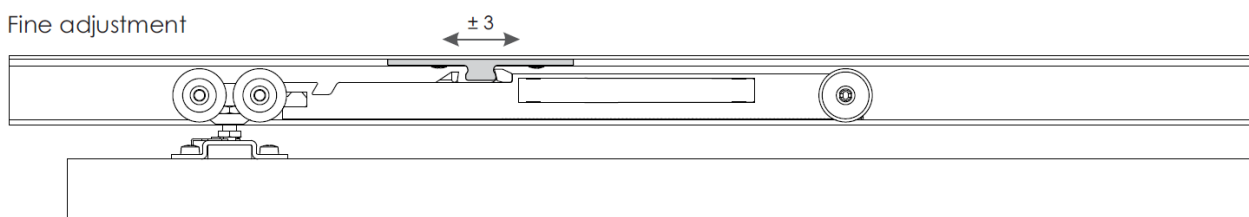

- 5** Adjust catch plate as required. Secure in final position with the 3rd screw.

