

INSTALLATION INSTRUCTIONS

ProLine 60 Surface Slider

COMPONENTS

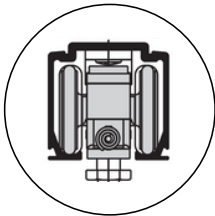

1 X TRACK

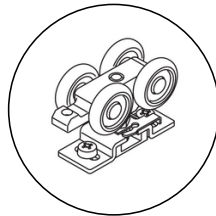

2 X HANGERS

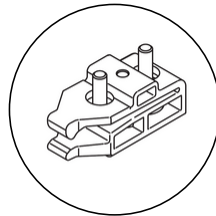

2 X CLIP STOPS

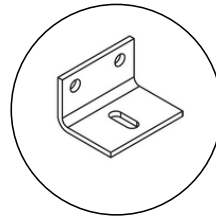

MOUNTING
BRACKETS

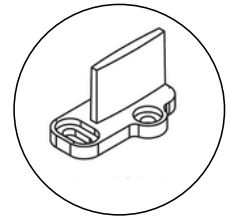

1 X T GUIDE

The aluminium track may be fitted directly to the lintel, in single or multiple lines, or face fitted to the lintel using a single line of brackets.

Fascia accessory with end caps also available on request.

Hangers come standard with a steel bracket and four nylon tyred wheels with precision bearings. Clip stops provided but can be upgraded to a soft close device for improved operation.

OPTIONAL SOFT CLOSE

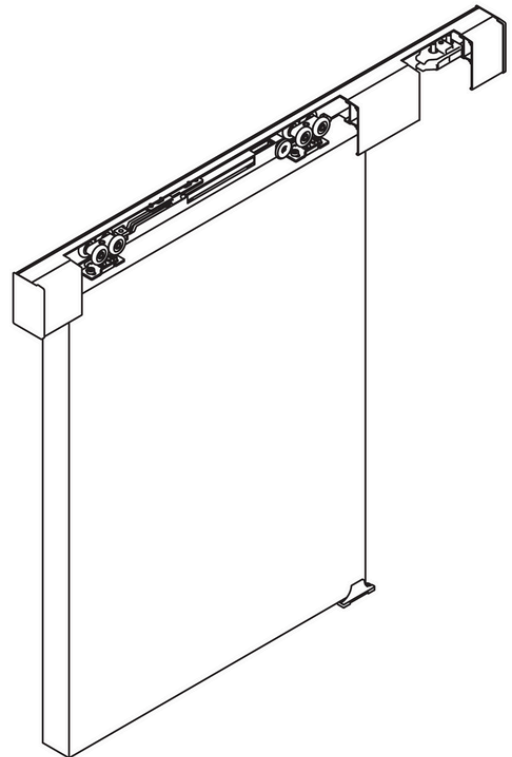
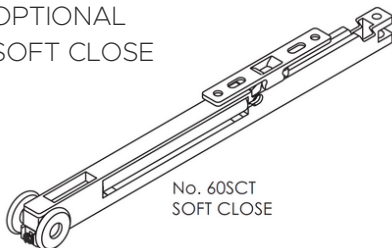

1. FIX TRACK

Ensure the track is mounted parallel to the floor.

Soffit Fix: position 8g screws first 50mm in from each end and then every 450mm approx centres.

Face Fix: use L shaped bracket (see qty chart below)

Track Length	2000mm	3000mm	4000mm	6000mm
Bracket Qty	5	8	10	15

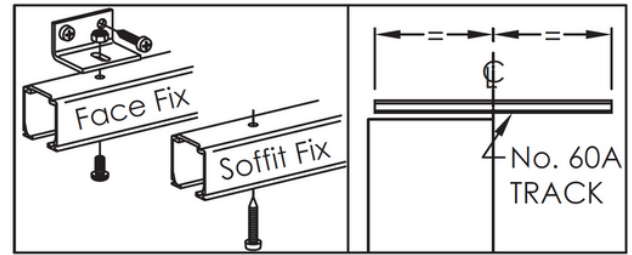

2. ATTACH HARDWARE TO PANEL

Rebate two 7mm deep (max) recesses in the top of the door 70mm in from each end. Fit hanger plates to the top of the door, one in each recess, with the lock tabs both on the same side of the door.

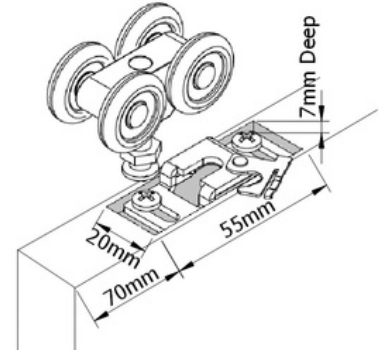

3. HANG DOOR

Insert wheels into the track. Place the door in line with the track and insert hanger bolt head into the slot in the hanger plate. Lock the bolt in place with the lock tabs. **5**

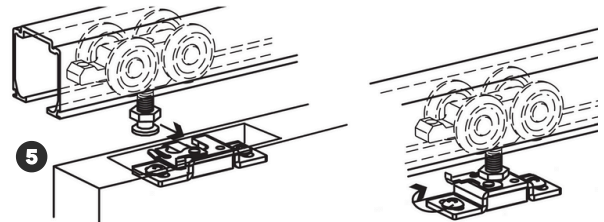

4. ADJUST PANEL

Screw bolt in or out of hanger to adjust panel height. Adjust height so panel is square.

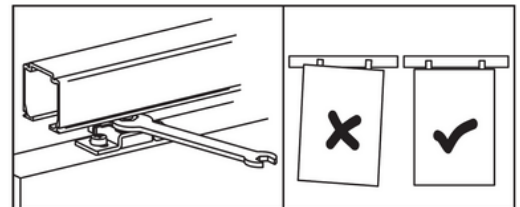

5. FIT GUIDE

Locate at opening jamb. With panel hanging plumb fix guide to the finished floor.

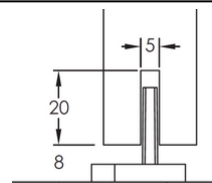

6. FIT CLIP STOPS OR SOFT CLOSERS

Clip Stop - 1 each end. Outer screws fixing. Inner screw adjusts strength of clipping. Soft close - install as per INST60SCT.

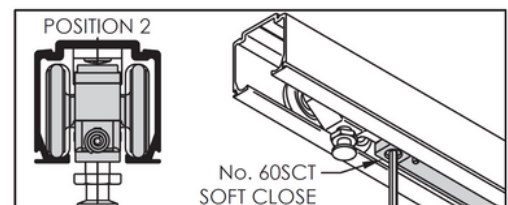
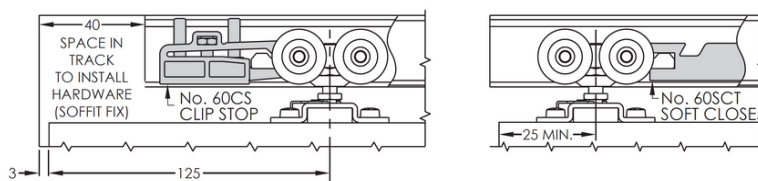

Product improvement is a continuous process & specifications are subject to change without notice.

© COPYRIGHT 2024 E&OE