

INSTALLATION INSTRUCTIONS

# Zero Clearance Surface Slider

## COMPONENTS

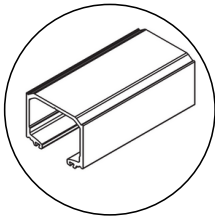

1 X TRACK

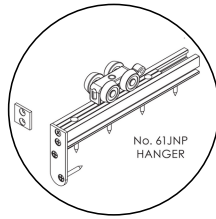

2 X HANGERS

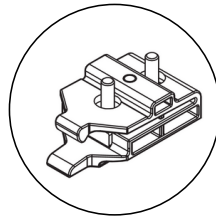

2 X CLIP STOPS

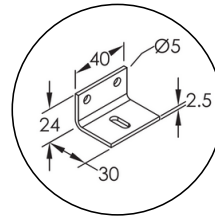

MOUNTING  
BRACKETS

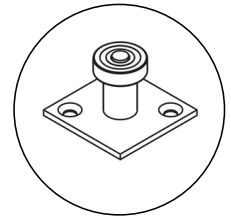

BOTTOM GUIDE

The aluminium track may be fitted directly to the lintel, in single or multiple lines, or face fitted to the lintel using a single line of brackets.

Fascia accessory with end caps also available on request.

Hangers come standard with a steel mounting bracket and four nylon tyred wheels with precision bearings. Clip stops are provided but can be upgraded to a soft close device for improved operation.

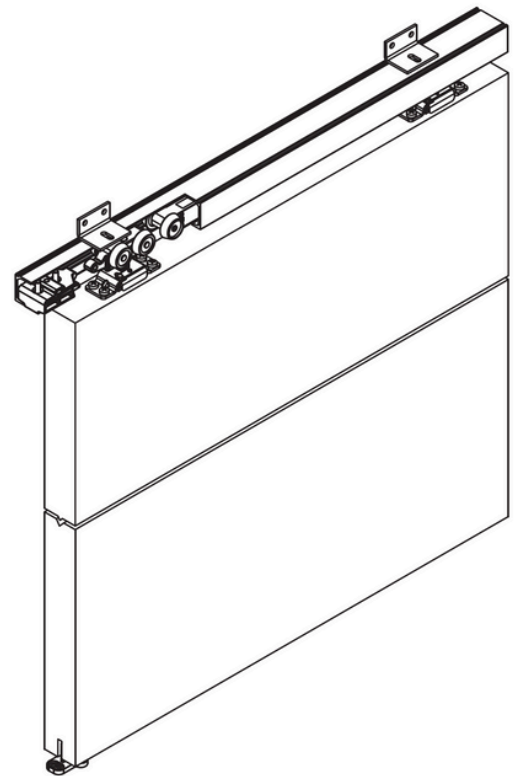

OPTIONAL  
SOFT CLOSE

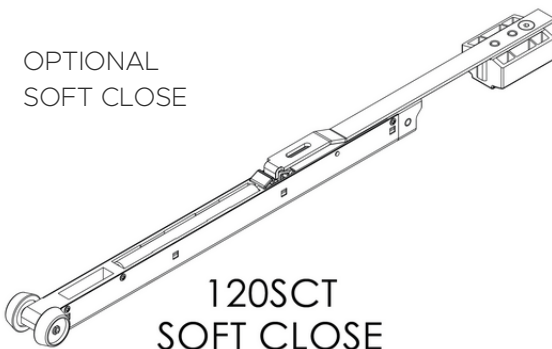

120SCT  
SOFT CLOSE

## 1. FIX TRACK

Ensure the track is mounted parallel to the floor.

Soffit Fix: position 8g screws first 50mm in from each end and then every 450mm approx centres.

Face Fix: use L shaped bracket (see qty chart below)

Track Length	2000mm	3000mm	4000mm	6000mm
Bracket Qty	5	8	10	15

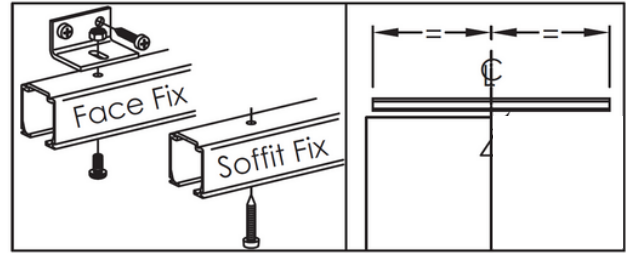

## 2. PANEL PREPARATION

Prepare the door panel for the mounting brackets.

IMPORTANT - Make sure the door you have has internal rails of at least 90mm at the top and bottom. This ensures that there is enough structure in the doors even after the rebates have been made to support the hanger plates. You might need to order a custom-made door to meet these specifications.

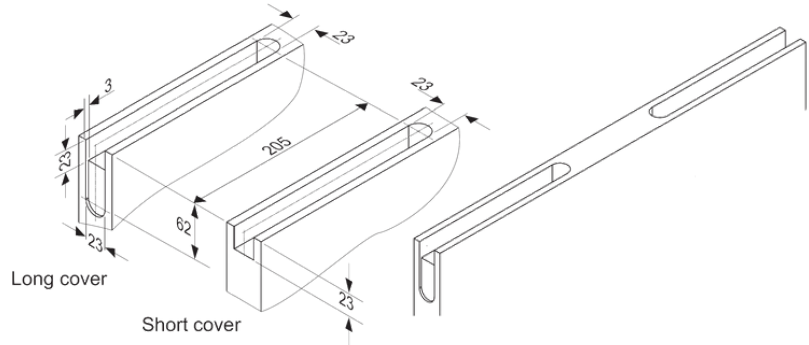

## 3. FIT HANGER PLATES

Fit outer extrusions into the rebates in the top of the door. Set 3mm back from the edge of the door so the cover plate is flush once screwed on. **6**

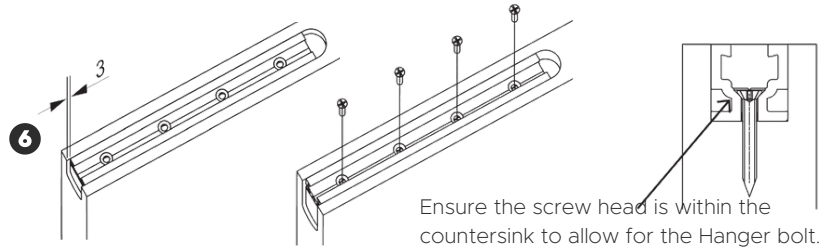

## 4. CLEARANCES

If you are using a soft closer you will need to ensure the bolt is not wound up too high otherwise it will catch on the soft close actuator hindering or possibly preventing the door to close fully.

Clearances without Soft Close	Clearances with Soft Close
3-5mm	7-10mm

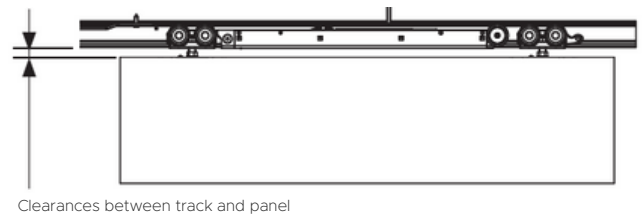

Clearances between track and panel

## 5. HANGER ASSEMBLY FOR SURFACE SLIDER

Assemble the hanger plate (inner extrusion) and bolt to the hanger.

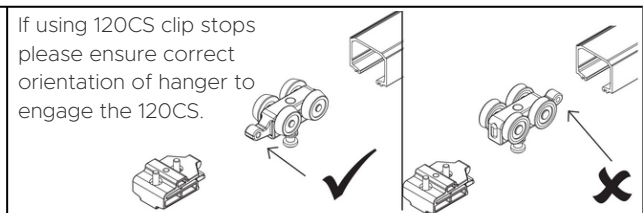
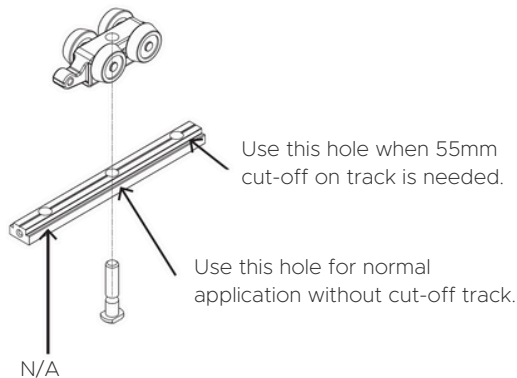

Ensure the flat sides of the hanger bolt are parallel to the sides of the hanger plate.

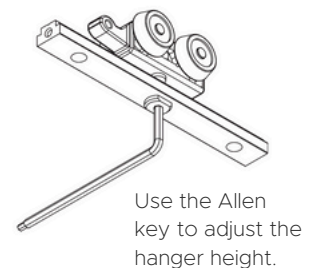
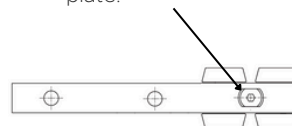

## 6. HANG DOOR

Insert wheels with bolt.

Adjust rear wheels to height required (4 – 6mm down from track).

Insert the rear inner extrusion into the rear outer extrusion, (already fixed into the rebate in the door). Secure inner extrusion with small stainless steel end plate (larger plate required for doors over 50kg).

Insert and fit front wheels as per rear set.

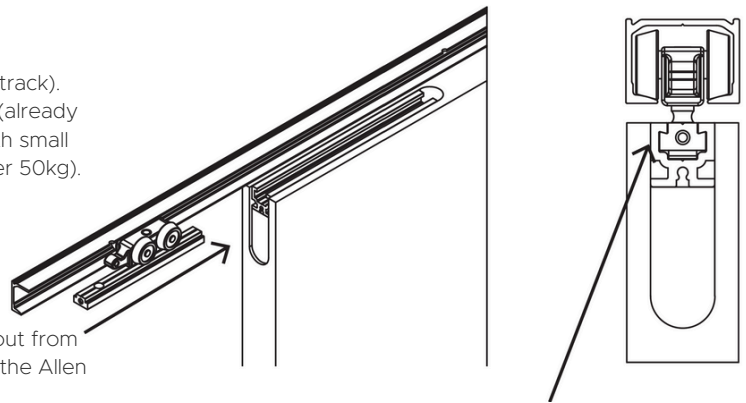

To adjust the panel height, firstly remove the hanger plate out from the retainer on panel and then rotate the hanger bolt using the Allen key. Clockwise to lower, anticlockwise to raise.

Ensure door is hanging level.

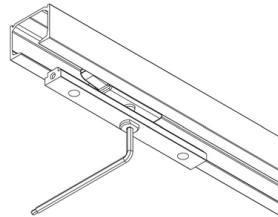

Ensure the end of the inner extrusion with the threaded hole is facing out.

## 7. FINISHING

Fix the cover plate to the panel using the screws supplied.

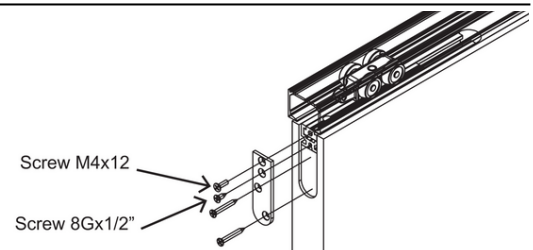

## 8. FIT CLIP STOPS OR SOFT CLOSES

Clip Stop - 1 for each end. The outer screws are for fixing. The inner screw adjusts strength of clipping.

If you're using a soft close the stop is part of the actuator - install as per 120SCT Instructions.

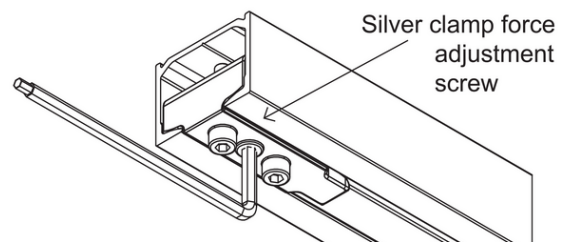

## 9. GUIDES

Fit roller guide to finished floor centrally beneath track above so the door hangs straight.

The roller guide will need to sit in the middle so it engage with the guide channel at all times. Screw aluminium channel into the rebate in the bottom of the door using countersunk screws.

- To further enhance the finish, stop the bottom guide channel rebate short from the edge of the door by 7-8mm from the leading edge of the door. **5**
- Ensure the guide channel is kept the same length as the width of the door so it remains engaged with the roller guide when in the closed position.
- Set the roller guide wheel back into the pocket from the face of the split jambs by 8mm.

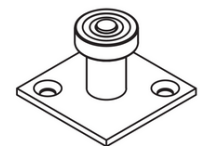
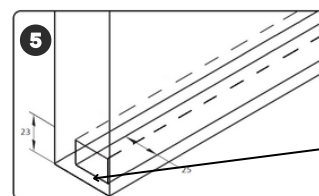

No. 104W/94PR  
GUIDE

STOP REBATE SHORT FROM  
EDGE OF DOOR BY 8MM

---

## 10. TO REMOVE DOOR

The door can be removed by reversing procedures 6 & 7.

---

## 11. CLIP ON FASCIA - OPTIONAL EXTRA

If you're using the clip on fascia this can be added to the side of the track with the end caps covering each end.

Fascia comes in clear anodised finish and needs to be requested as additional item.

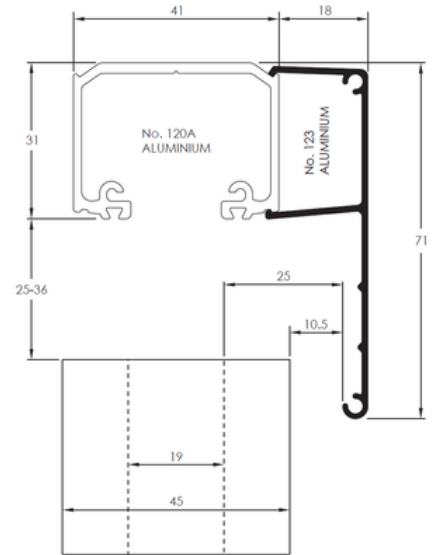

---

## 12. CARE AND MAINTENANCE

### General

Inspect all fixing bolts for tightness every six months, including those securing brackets. Tighten if necessary. Routinely check for wear and if excessively worn, the part should be replaced.

To help prevent surface corrosion, wash regularly with soap or mild detergent and warm water followed by rinsing with clean cold water and wipe dry.

### Track

Keep track free from obstruction and excessive dirt or water. Visible surfaces should be cleaned using a damp cloth and mild detergent, then wiped dry.

### Hangers

All hangers are fitted with lubricated ball-bearings, requiring no greasing. If doors 'settle' and door clearance is reduced causing friction, raise the door by the hanger adjustment nuts. Wash as per the above recommendation and apply a light application of corrosion preventative to all surfaces, using a dry cloth to remove excess.

### Guides

Guide roller and guide channel must be kept clear and free of obstructions. Wash as per the above recommendation and apply a light application of corrosion preventative to all surfaces, using a dry cloth to remove excess.

Product improvement is a continuous process & specifications are subject to change without notice.

© COPYRIGHT 2024 E&OE