



Triline Cavity Slider Selection Sheet

Name: _____ Your Company: _____
 Phone: _____ Preferred Reseller: _____
 Date: _____ Reseller Email: _____
 Door #: _____ Job Reference: _____

Qty: _____

Cavity Type

Traditional - Pelmet Style

- Phoenix 60kg (Standard)
- Hercules 120kg



Architectural - No Pelmet

- ProLine 60kg
- Zero Clearance 120kg
- Frameless Glass

Accessible & Auto

- Access Cavity - AS1428.1-2009 Compliant
- Auto Cav 80 - Automatic Cavity Slider

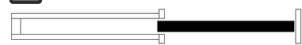
Configuration

- Single 
- Double Overtaker 

- Double 
- Triple Overtaker 

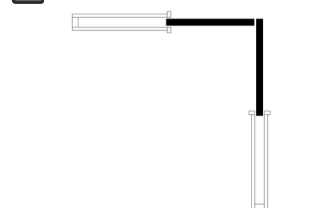
- Corner Meeting Unit 

Head Detail

- Bulk Head (Less than full height)

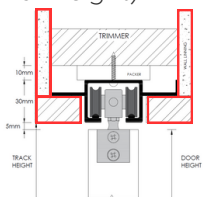

- Full Height (floor to ceiling)

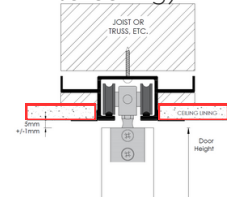

- Half Full Height - LH Bulk Head

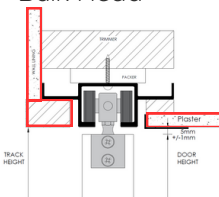

- Half Full Height - RH Bulk Head

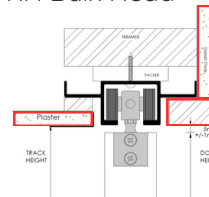

NOT AVAILABLE FOR PHOENIX OR HERCULES

Jamb Detail

- Architraves 

- P25 - Square Stop 

- P50 Shadow Line 

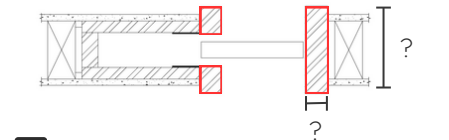
- Express Jamb or Thick Reveals 

- EzyJamb - Kit Included 

- Flat Faced Cap 

- or Rebated Cap 

- or Fast Cap 

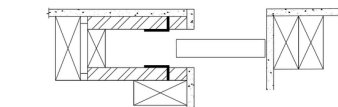
- End of Hallway - LH 

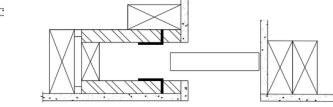
- End of Hallway - RH 

- Full Width of Hallway 

Accessories

- Soft Close
- Pocket Door Release
- Cavity Switch Unit
- Self Close

Dimensions (Critical Only)

Door Height: _____ Door Width: _____
 Clear Opening Height: _____ Clear Opening Width: _____
 Stud Opening Height: _____ Stud Opening Width: _____

Stud Width: _____
 Lining: _____
 Door Thickness: _____
 Flush Jamb:
 OR Flush Pull:
 (50mm Projection)
 or Nominate Other: _____

Extra Notes:
 (e.g. floor covering thickness,
 no closing jamb, etc.)